

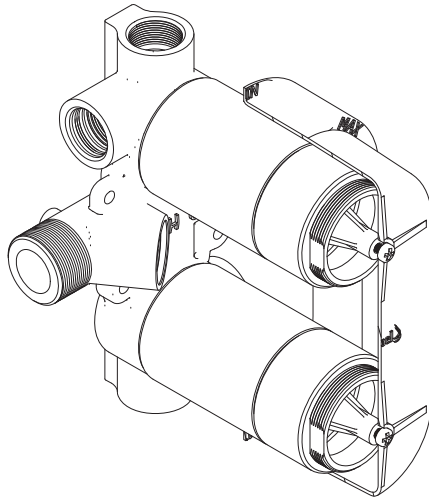

Installation guide / Guide d'installation / Guía de instalación



**Before beginning the installation:**

Read all instructions.  
Purge the water supply system before connecting it to the faucet.

**Avant de commencer l'installation :**

Lire toutes les instructions.  
Purger votre système d'alimentation d'eau avant d'effectuer le branchement au robinet.

**Antes de iniciar la instalación:**

Lea todas las instrucciones.  
Es necesario purgar previamente su sistema de alimentación de agua para efectuar la conexión del grifo.

**Tools and equipment required.**

**Outils et matériel requis.**

**Herramientas y material requerido para instalación:**



riobel.ca

GUI-46-rough-Rev00

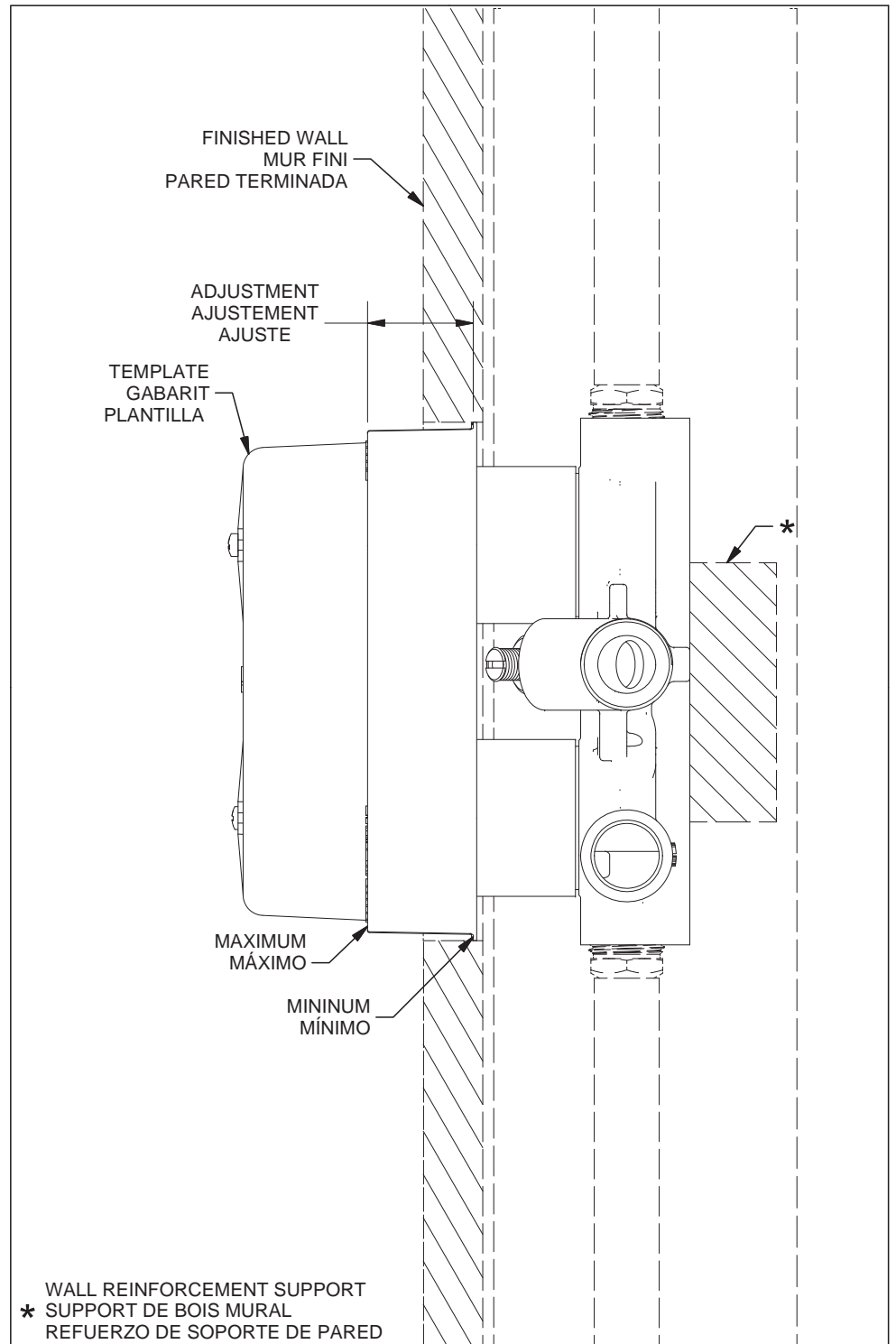

WALL REINFORCEMENT SUPPORT  
\* SUPPORT DE BOIS MURAL  
REFUERZO DE SOPORTE DE PARED

USA / QC : 1.866.473.8442 - ONT : 1.888.287.5354

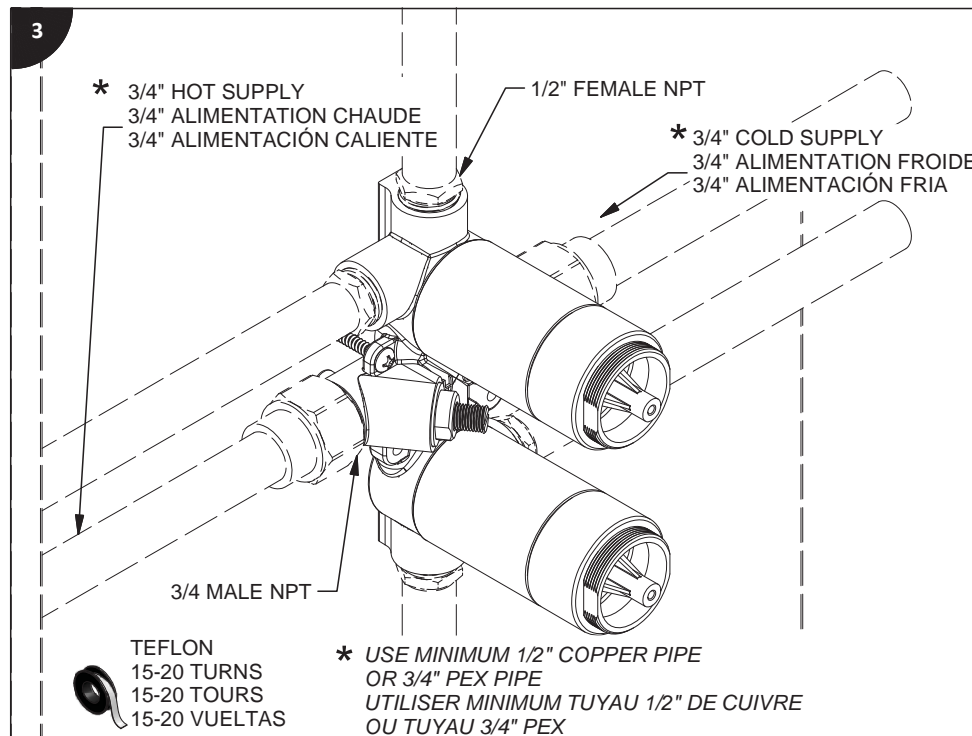
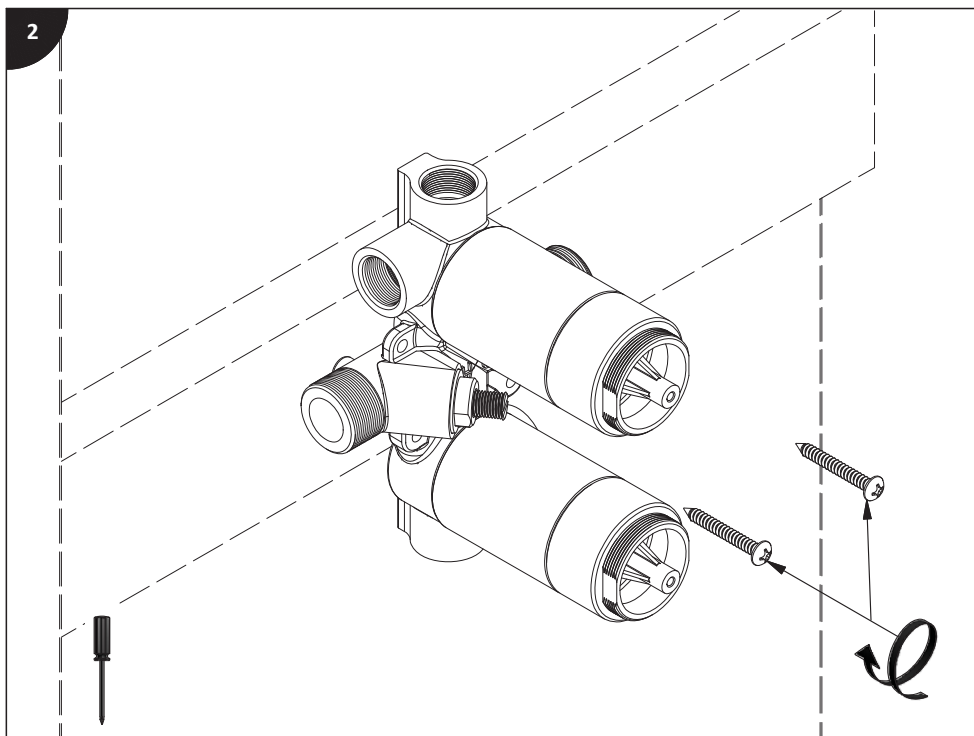
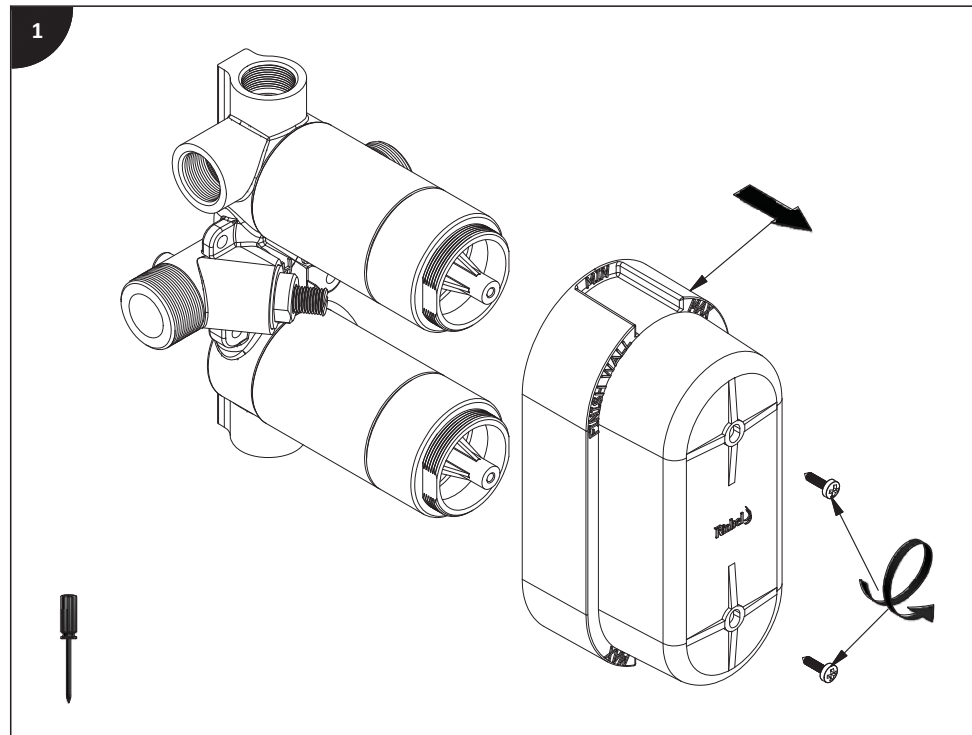
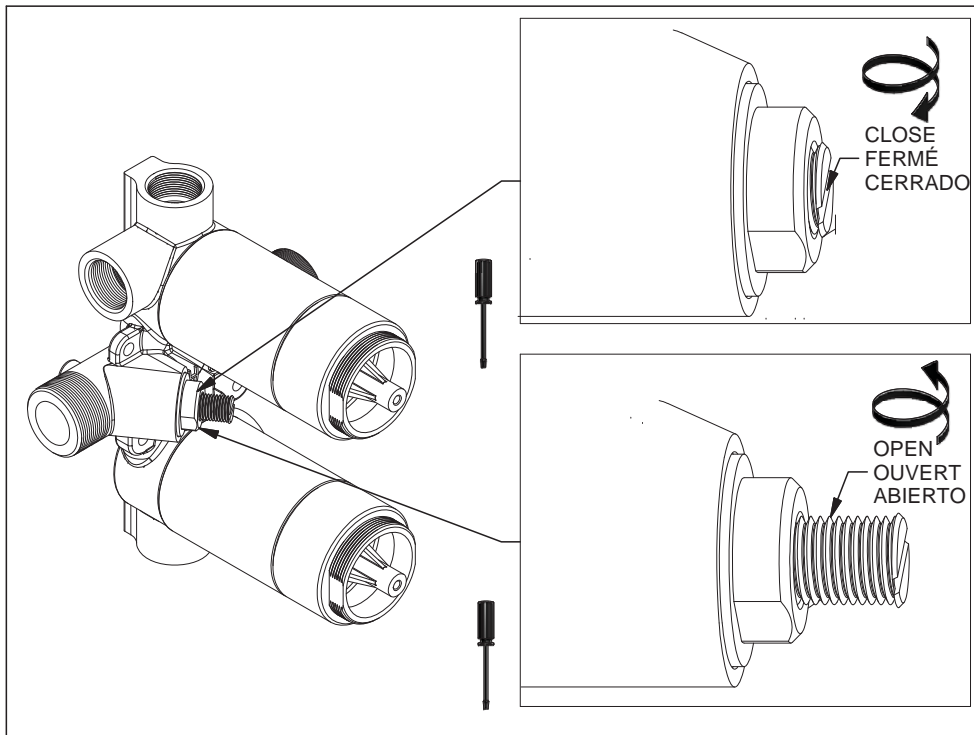

4

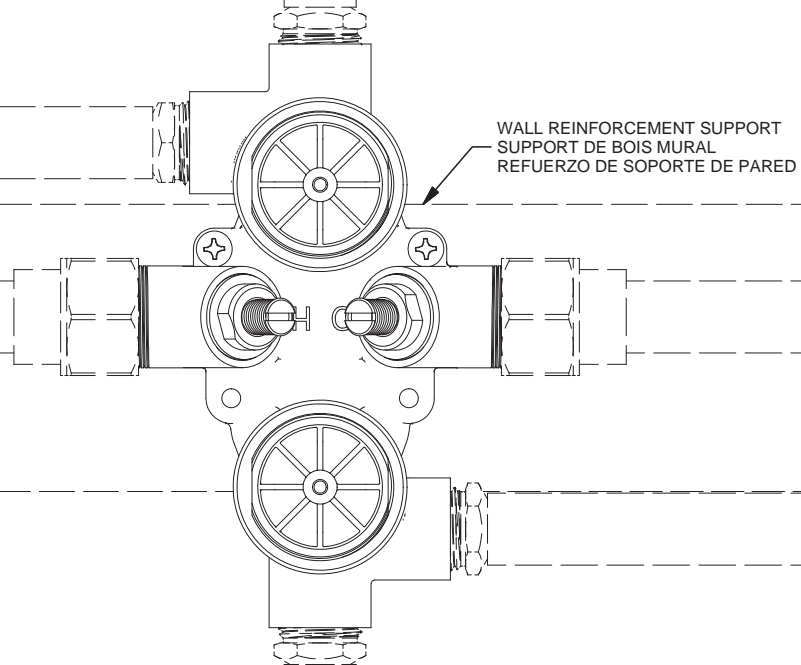

WALL REINFORCEMENT SUPPORT  
 SUPPORT DE BOIS MURAL  
 REFUERZO DE SOPORTE DE PARED



✓  
 CHECK  
 VÉRIFIER  
 VERIFICAR

**CAP OUTLET TO KEEP UNDER PRESSURE**  
**BLOQUER LES SORTIES POUR GARDER SOUS PRESSION**  
**TAPE LAS SALIDAS PARA MANTENER BAJE PRESION**

5

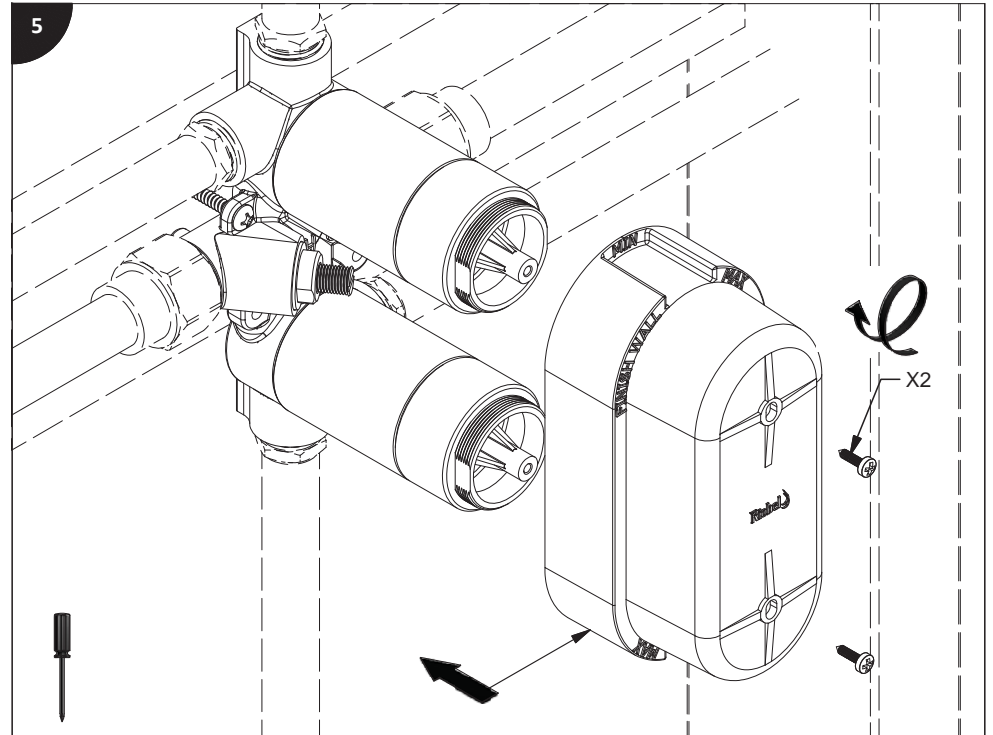

X2

FINISHED WALL  
 MUR FINI  
 PARED TERMINADA

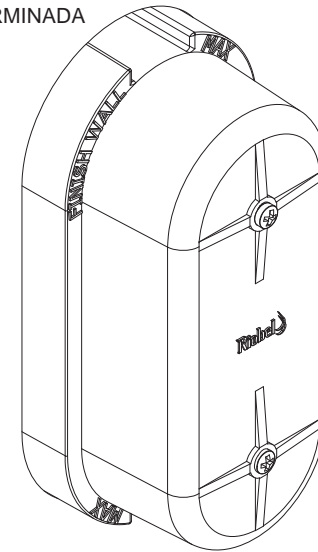

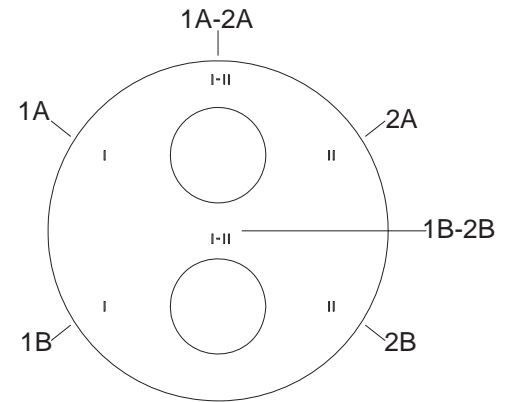
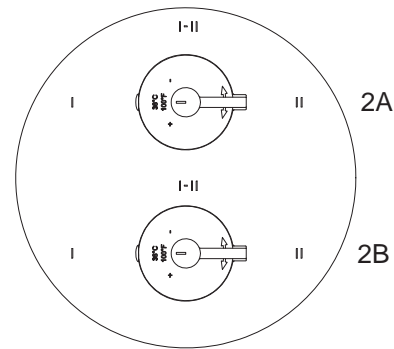
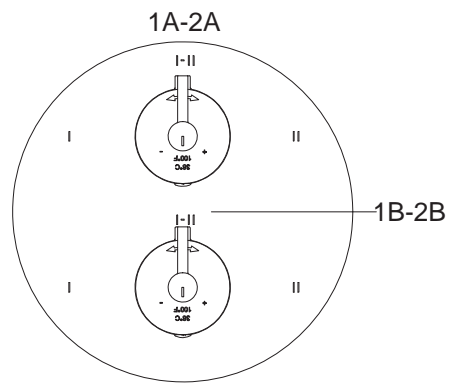
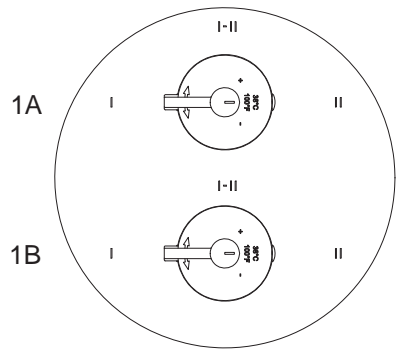
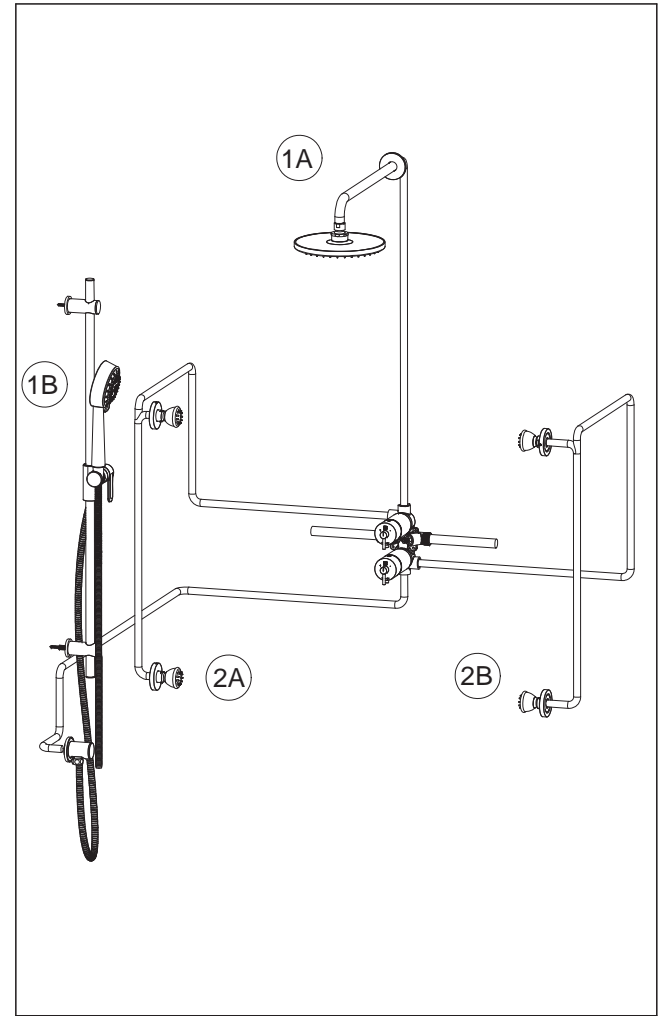
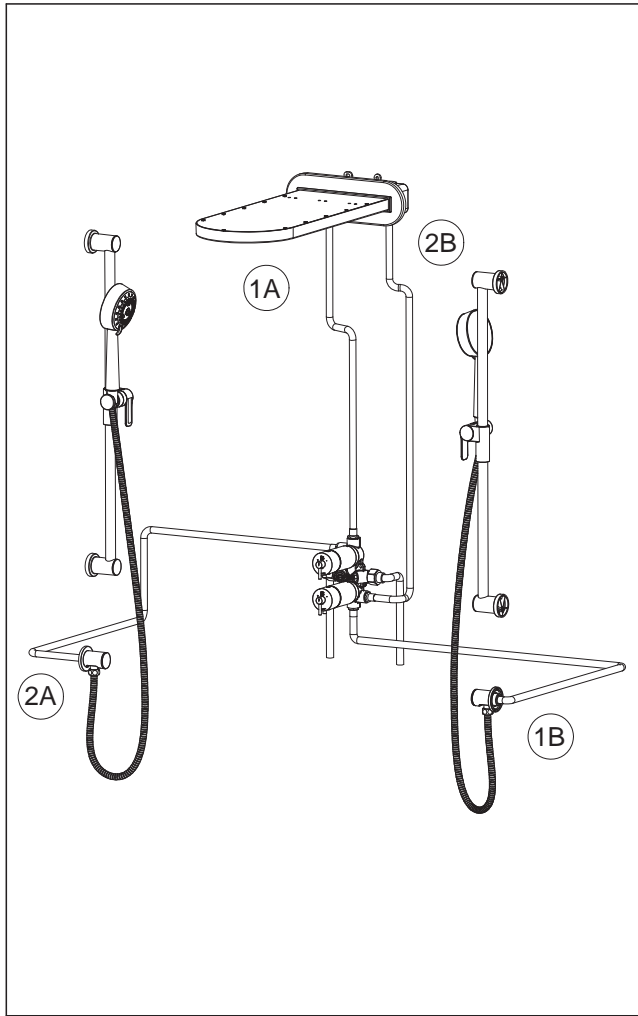
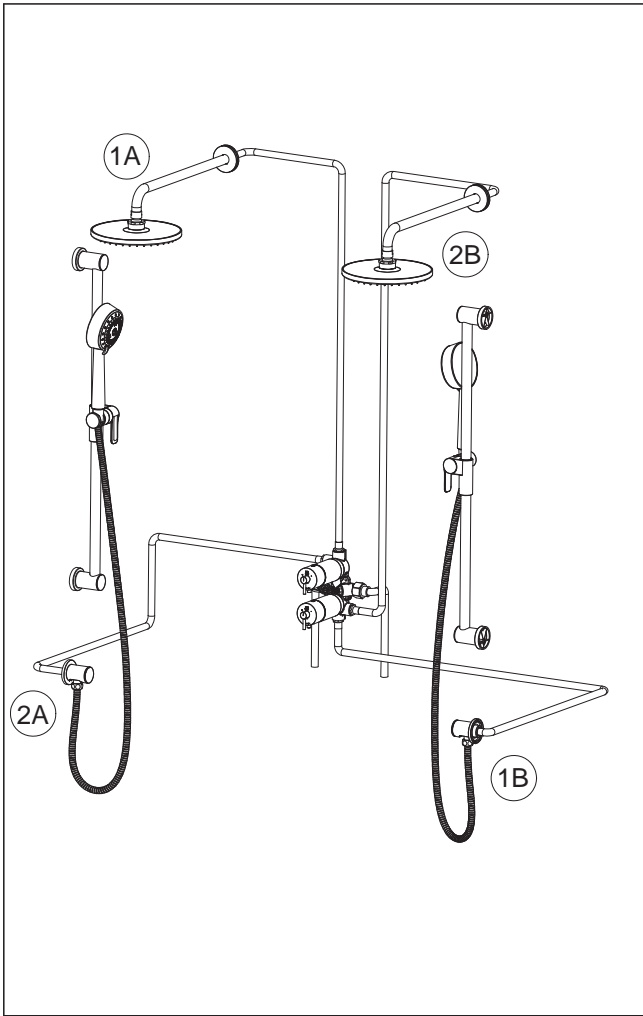



Installation guide / Guide d'installation / Guía de instalación

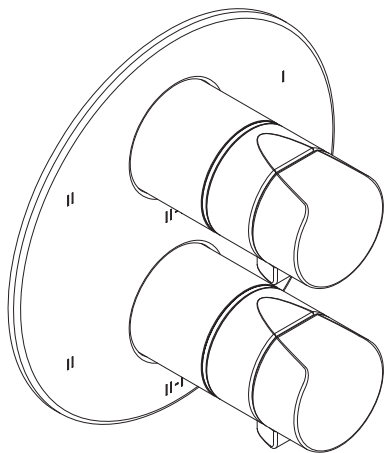

**Before beginning the installation:**

Read all instructions.

Purge the water supply system before connecting it to the faucet.

Type TP - For use with shower heads rated at 7L/min (1.8 gpm) or higher

**Avant de commencer l'installation :**

Lire toutes les instructions.

Purger votre système d'alimentation d'eau avant d'effectuer le branchement au robinet.

Type TP - Utiliser avec une tête de douche de 7L/min (1.8 gpm) ou plus

**Antes de iniciar la instalación:**

Lea todas las instrucciones.

Es necesario purgar previamente su sistema de alimentación de agua para efectuar la conexión del grifo.

Tipo TP – Utilizar con una regadera de ducha de 7L/min (1.8gpm) o más

**Tools and equipment required.**

**Outils et matériel requis.**

**Herramientas y material requerido para instalación:**

