

# Begonia Soho 36 x 36 Polystyrene Center Drain Shower Kit

**Model number:**

105618-000-129-102

**Dimensions:** 36" x 36" x 72"

**Installation:**

**Material:** Polystyrene



## Standard Features:

- Shower kit includes: neo-angle shower base, door and wall
- Offered with a chrome door finish and white base
- Reversible pivot door for left or right-hand opening, giving you flexibility in design

- Practical shower kit with an All-In-One-Box-Solution

- Plastic injected shower base with a textured floor

## Product characteristics:

- Made in Canada
- All-In-One Box Solution
- Textured Floor

## Standard Colors:



White

## Frame Finish(es):



Chrome

## Glass Pattern(s):



Soho

## Certifications

MAAX products adhere to one or more of the following certifications:



# MAAX

# Begonia Soho 36 x 36 Polystyrene Center Drain Shower Kit

**Model number:**

105618-000-129-102

**Dimensions:** 36" x 36" x 72"

**Installation:**

**Material:** Polystyrene

## Dimensions

36 x 36 x 72 In.  
(914 x 914 x 1829 mm)

## Weight

104 lbs - 47 1/4 kg

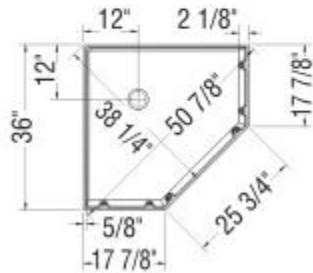
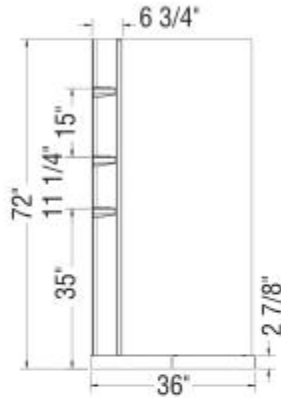

All dimensions are approximate. Structure measurements must be verified against the unit to ensure proper fit.

Project: \_\_\_\_\_

Contractor: \_\_\_\_\_

Representative: \_\_\_\_\_

Date: \_\_\_\_\_

Tel: \_\_\_\_\_

Notes: \_\_\_\_\_

# MAAX