

# VB1331(X)(R)#RB

VB1331#RB  
 VB1331R#RB  
 VB1331X#RB

VB1331XR#RB

## Vacuum Breaker & Angle Stop Set for Toilet w/ Concealed, Back Spud 1-1/2" Outlet

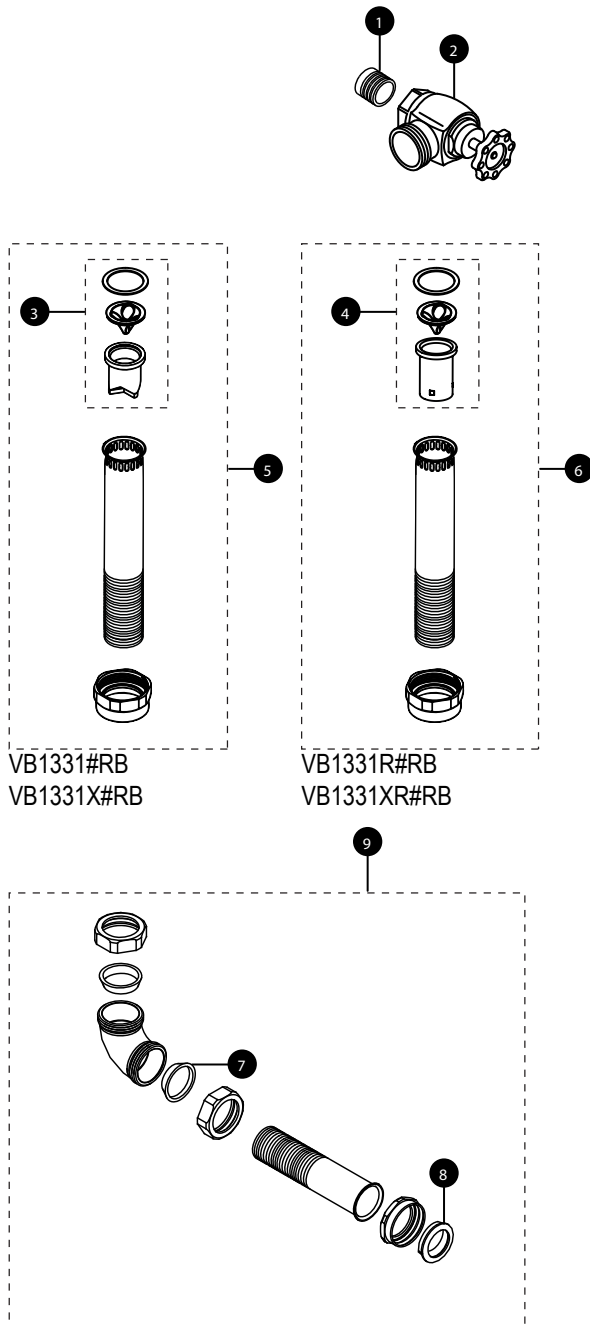

Item	Part	Description
1	SJ3	Solder Adapter 1"
	THP3317	Solder Adapter 1" RW*
2	10077T5	Angle Stop (1") Toilet - Rough Brass
	THP3314#RB	Angle Stop (1") Toilet - Rough Brass RW*
3	THP3292	Vacuum Breaker Repair Kit
4	THP3545	Vacuum Breaker Repair Kit (Skirted)
5	THP3287#RB	Tube Assembly (1-1/2" x 13") for VB1331#RB
	THP3327#RB	Tube Assembly (1-1/2" x 13") RW* for VB1331X#RB
6	THP3287#RB	Tube Assembly (1-1/2" x 13") for VB1331R#RB
	THP3327#RB	Tube Assembly (1-1/2" x 13") RW* for VB1331XR#RB
7	THU3011	1-1/2" Tubular Washers (set of 5 pc)
8	THU3012	1-1/2" Flanged Washers (set of 5 pc)
9	TH559EDV176	Outlet Tube - Back Spud - Wall Mount Bowl
	THP3508	Outlet Tube - Back Spud - Wall Mount Bowl RW*

\* RW = for Reclaimed Water. Includes VB1331X#RB, VB1331XR#RB

Note: For Reclaimed Water (RW) applications use the RW version parts where applicable. Do not use standard vacuum breaker, standard control stop, or components with reclaimed water flush valve.